



## 9 Brush Road Eastwood NSW

7 4 3

- Tri level architecturally designed home with seven Bedrooms and four Bathrooms
- Smart Home control system installed throughout the home to ensure convenience and comfort
- Open plan living with multiple living areas to exemplify luxurious lifestyle with District views and gas fireplace
- Gourmet kitchen with Caesar stone benchtops, soft close cabinetry and SMEG appliances with gas cooking
- Double bedrooms with walk in wardrobes
- Master bedroom with en-suite and private walk in wardrobe
- Four opulent marble bathrooms
- Ducted air conditioning throughout the home complete with zone control
- Alfresco entertaining area with BBQ facilities overlooking Panoramic Private View and outdoor kitchen
- Sun filled with high ceilings complete with LED lighting

**View :** <https://www.jt-property.com.au/lease/nsw/northern-suburbs/eastwood/residential/house/7153838>



**Vanessa Elias**  
0434 341 755

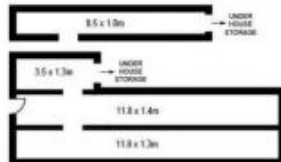

This Floor Plan was prepared by WWW-CRYINGOUTLOUD.COM.AU for illustration purposes only. This document does not constitute any part of an offer or contract. Dimensions are approximate only. Copyright ©2019 Crying Out Loud. All Right Reserved.

APPROX. INT : 463m<sup>2</sup>



9 Brush Road, Eastwood